

This drawing is the copyright of Harding Neill & Watson, Architects.
 All dimensions must be verified on site prior to construction.
 Do not scale this drawing except for Planning Application purposes.
 Ordnance Survey Licence No. 100000200

Rev	Amendments	By	Chkd	Date
P1	PLANNING ISSUE	SJL	RT	17/03/09

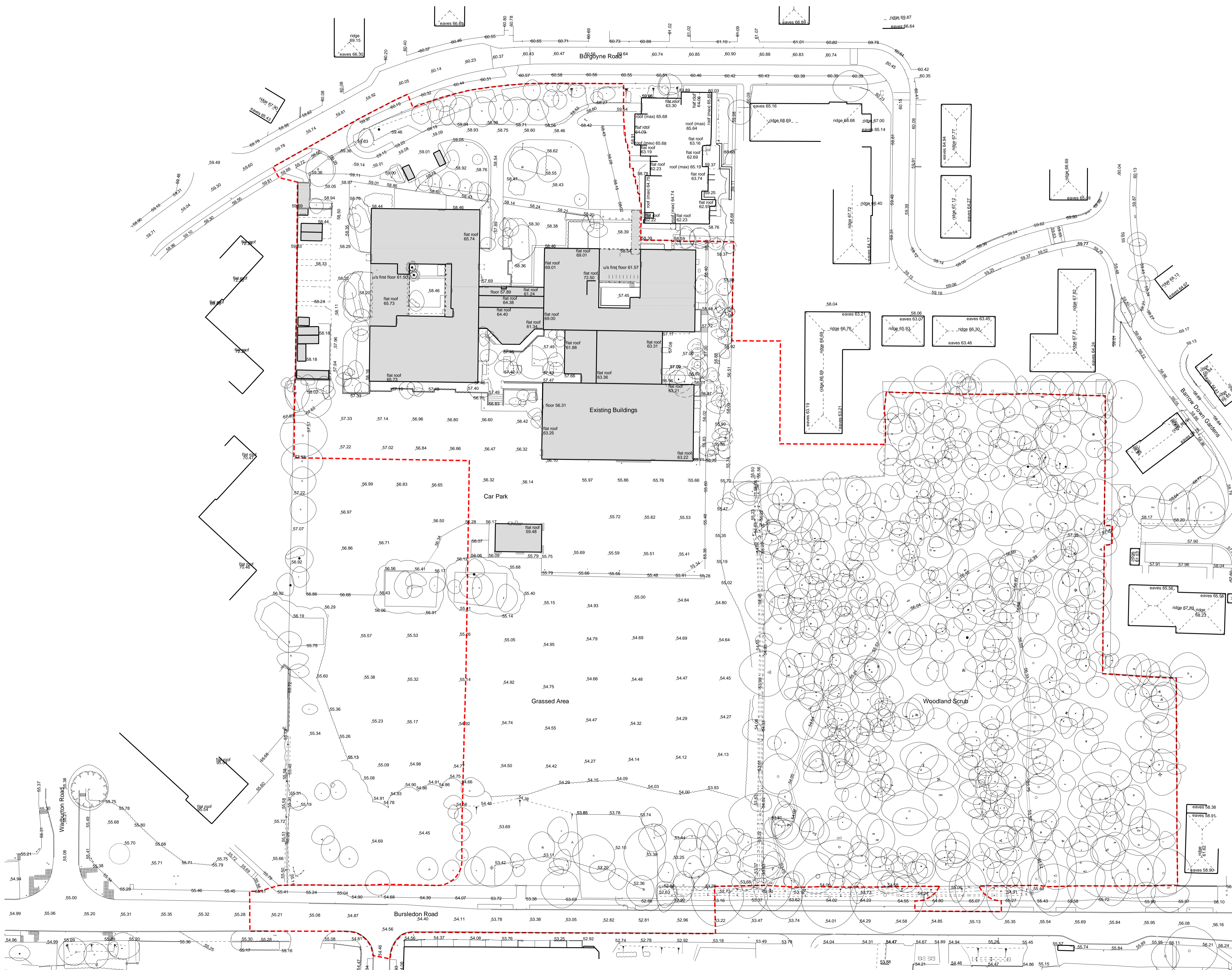

- Key:**
- BT British Telecom
 - CB Control Box
 - CL Cover Level
 - CTV Cable Television
 - EL Electric
 - EP Electricity Pole
 - FH Fire Hydrant
 - GSSV Gas Stop Valve
 - HT Height
 - HVC High Voltage Cable
 - IC Inspection Cover
 - IL Invert Level
 - LP Lamp Post
 - MH Man-Hole
 - MKR Marker
 - O/H Overhead
 - G Road Gully
 - PB Post Box
 - RNP Road Name Plate
 - RS Road Sign
 - SS/A Soakaway
 - ST Stay / Strut
 - GSV Stop Valve (Unidentified)
 - IB Telephone Box
 - TH Trial Hole
 - TL Traffic Light
 - TP Telegraph Pole
 - UTL Unable to Lift
 - VP Vent pipe
 - WM Water Meter
 - WSV Water Stop Valve

Application Boundary - - - - -

Note: All levels relative to Above OS Datum.

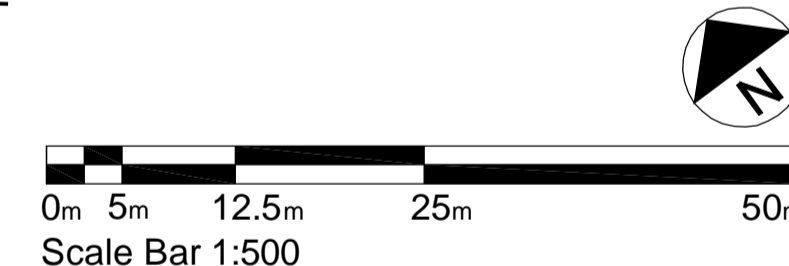

HNW Architects, 11 West Pallant, Chichester, West Sussex, PO19 1TB
 Tel: 01243 533300 Fax: 01243 533311 E-mail: hnw@hnw.co.uk www.hnw.co.uk

Project

ITCHEN COLLEGE

Drawing Title
EXISTING SITE PLAN

Drawing Status
PLANNING

Scale 1:500@A1 Drawn By SJL Date JAN 2009

Checked By RT Date JAN 2009

Project No. 08024 Drawing No. P101 Revision P1