

Rev	Amendments	By	Chkd	Date
P1	Formal issue of preliminary Masterplan for comment	sjd	rt	29/01/09
P2	Section lines added	sjd	rt	30/01/09
P3	General amendments to accord with revised proposals and highway implication.	rt	sl	13/02/09
P4	Car Park Amendments	rt	sl	16/02/09
P5	Boundary Amendments	sl	mb	04/03/09
P6	Emergency Access moved east 4m PLANNING ISSUE	rt	sl	13/03/09

NB: Layout subject to introduction of possible electrical sub-station for College building

ITCHEN COLLEGE & NURSERY
 160 no Staff, Visitor and Student car parking spaces, including 8 no disabled & 4 no mother & baby spaces.
 Plus 2 no College minibus parking spaces.

50 no Motor cycle parking bays with security bollard.

60 no covered Bicycle rack positions.

DAY CARE CENTRE
 4 no car parking spaces including 2 no disabled.
 3 no minibus drop off spaces.

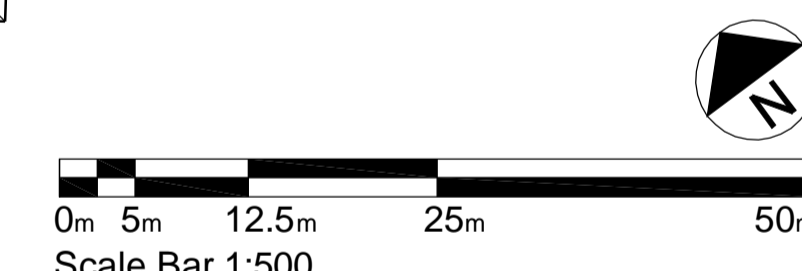
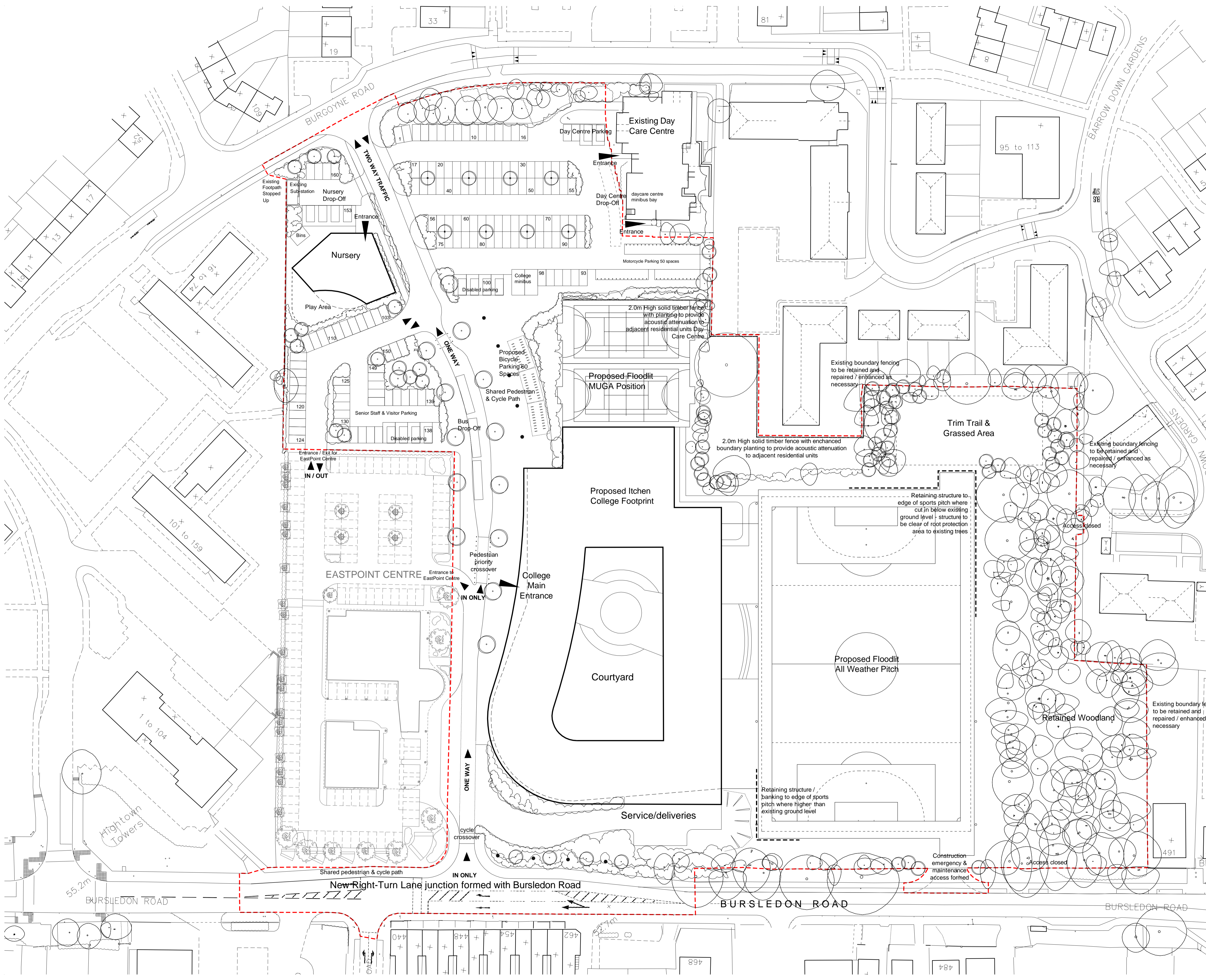

HNW Architects, 11 West Pallant, Chichester, West Sussex, PO19 1TB
 Tel: 01243 533300 Fax: 01243 533311 E-mail: hnw@hnrw.co.uk www.hnrw.co.uk

Project

ITCHEN COLLEGE

Drawing Title
PROPOSED MASTERPLAN

Drawing Status
PLANNING

Scale 1:500@A1 Drawn By SJD Date JAN 2009

Checked By RT Date JAN 2009

Project No. 08024 Drawing No. P103 Revision P6