

Reference: 2013/02150/01SPRV

Hearing: 7th November 2013

APPLICATION TO VARY A PREMISES LICENCE

Premises Name: Genting Club Terminus Terrace Application Date: 10th September 2013

Premises Address: Terminus House Application Received Date: 12th September 2013
 Terminus Terrace
 Southampton
 SO14 3FE

Application Valid Date: 12th September 2013

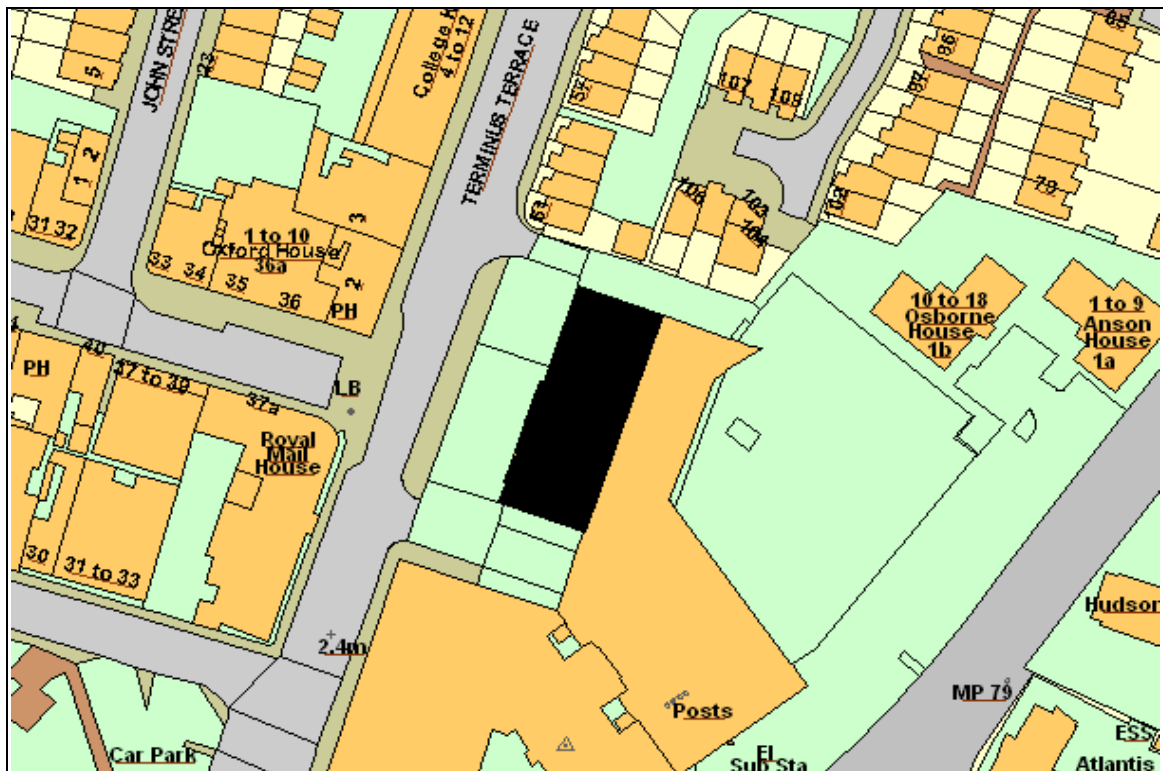

This map is reproduced from Ordnance Survey material with the permission of Ordnance Survey on behalf of the Controller of Her Majesty's Stationery Office © Crown copyright. Unauthorised reproduction infringes Crown copyright and may lead to prosecution or civil proceedings. Southampton City Council Licence No. 100019679 2007.

Representations From Responsible Authorities

Responsible Authority	Satisfactory?	Comments
Child Protection Services - Licensing	Yes	

Hampshire Fire And Rescue - Licensing	Yes	
Environmental Health - Licensing	Yes	
Planning & Sustainability - Building Control - Licensing	Yes	
Primary Care Trust - Public Health Manager	No Response Received	
Planning & Sustainability - Development Control - Licensing	Yes	
Police - Licensing	No	
Trading Standards - Licensing	Yes	

Other Representations

Name	Address	Contributor Type
Ms. Sonja Angus	108 Imperial Apartments South Western House Southampton SO14 3AL	Resident
Mr. David Riley	2 Terminus Terrace Southampton SO14 3DT	Resident

Legal Implications

1. The Licensing Act 2003 specifically restricts the grounds on which the Council, as Licensing Authority (LA), may refuse an application for a major variation of a Premises Licence, or impose conditions. Where relevant representations are made, the LA may refuse on the grounds that the licensing objectives are not met or the operating schedule is inadequate. Equally, conditions may be imposed where relevant and necessary. The LA may also refuse an application in part and thereby only permit some of the licensable activities sought.
2. The decision making committee, in considering an application, must have regard to the adopted Statement of Licensing Policy and any relevant representations made by those directly affected.
3. An applicant for a variation, whose application has been refused, or who is aggrieved by conditions imposed, may appeal against the decision to the Magistrates' Court.
4. In considering this application the committee will sit in a quasi-judicial capacity and is thus obliged to consider applications in accordance with both the Licensing Act 2003 (Hearings) Regulations 2005, and amending secondary legislation and the rules of natural justice. The practical effect of this is that the committee must make its decision based on evidence submitted in accordance with the legislation and give adequate reasons for reaching its decision.

The committee must also have regard to:-

5. *Crime and Disorder Act 1998*
Section 17 of the Crime and Disorder Act 1998 places the Council under a duty to exercise its various functions with due regard to the likely effect of the exercise of those functions on, and the need to do all that it reasonably can to prevent, crime and disorder in its area.
6. *Human Rights Act 1998*
The Act requires UK legislation to be interpreted in a manner consistent with the European Convention on Human Rights. It is unlawful for the Council to act in a way that is incompatible (or fail to act in a way that is compatible) with the rights protected by the Act. Any action undertaken by the Council that could have an effect upon another person's Human Rights must be taken having regard to the principle of Proportionality - the need to balance the rights of the individual with the rights of the community as a whole. Any action taken by the Council which affects another's rights must be no more onerous than is necessary in a democratic society. The matter set out in this report must be considered in light of the above obligations.

Application to vary a premises licence under the Licensing Act 2003

PLEASE READ THE FOLLOWING INSTRUCTIONS FIRST

Before completing this form please read the guidance notes at the end of the form.
If you are completing this form by hand please write legibly in block capitals. In all cases ensure that your answers are inside the boxes and written in black ink. Use additional sheets if necessary.

You may wish to keep a copy of the completed form for your records.

I/We Genting Casinos UK Limited

(Insert name(s) of applicant)

being the premises licence holder, apply to vary a premises licence under section 34 of the Licensing Act 2003 for the premises described in Part 1 below

Premises licence number 2012/00566/01 SPRD
--

Part 1 – Premises Details

Postal address of premises or, if none, ordnance survey map reference or description Genting Club Terminus Terrace Terminus House Terminus Terrace			
Post town	Southampton	Post code	SO14 3FE

Telephone number at premises (if any)	023 8022 1021
Non-domestic rateable value of premises	£125000+

Part 2 – Applicant details

Daytime contact telephone number	0121 325 7780		
E-mail address (optional)			
Current postal address if different from premises address	Genting Casinos UK Limited Genting Club Star City Watson Road		
Post Town	Birmingham	Postcode	B7 5SA



Part 3 - Variation

Do you want the proposed variation to have effect as soon as possible?

Please tick yes

If not do you want the variation to take effect from

Day	Month	Year

Please describe briefly the nature of the proposed variation (Please see guidance note 1)
In summary the application is to vary the Premises Licence and Premises Licence Plans to extend the area licensed for the sale of alcohol and late night refreshment into the external area at the front of the premises as more particularly shown on the proposed amended Premises Licence Plan that accompanies this application and accordingly the application also requests the removal of existing condition stating "all activities permitted by this Licence shall take place inside the Licensed Premises".

If your proposed variation would mean that 5,000 or more people are expected to attend the premises at any one time, please state the number expected to attend

0 N/A

Part 4 Operating Schedule

Please complete those parts of the Operating Schedule below which would be subject to change if this application to vary is successful.

Provision of regulated entertainment

Please tick yes

- a) plays (if ticking yes, fill in box A)
- b) films (if ticking yes, fill in box B)
- c) indoor sporting events (if ticking yes, fill in box C)
- d) boxing or wrestling entertainment (if ticking yes, fill in box D)
- e) live music (if ticking yes, fill in box E)
- f) recorded music (if ticking yes, fill in box F)
- g) performances of dance (if ticking yes, fill in box G)
- h) anything of a similar description to that falling within (e), (f) or (g) (if ticking yes, fill in box H)

Provision of entertainment facilities:

- i) making music (if ticking yes, fill in box I)
- j) dancing (if ticking yes, fill in box J)
- k) entertainment of a similar description to that falling within (i) or (j) (if ticking yes, fill in box K)

Provision of late night refreshment (if ticking yes, fill in box L)

Sale by retail of alcohol (if ticking yes, fill in box M)

In all cases complete boxes N, O and P

A

Plays Standard days and timings (please read guidance note 6)			<u>Will the performance of a play take place indoors or outdoors or both – please tick</u> (please read guidance note 2)	Indoors	<input type="checkbox"/>
				Outdoors	<input type="checkbox"/>
				Both	<input type="checkbox"/>
Day	Start	Finish	<u>Please give further details here</u> (please read guidance note 3)		
Mon					
Tue			<u>State any seasonal variations for performing plays</u> (please read guidance note 4)		
Wed					
Thur			<u>Non standard timings. Where you intend to use the premises for the performance of plays at different times to those listed in the column on the left, please list</u> (please read guidance note 5)		
Fri					
Sat					
Sun					

B

Films Standard days and timings (please read guidance note 6)			<u>Will the exhibition of films take place indoors or outdoors or both – please tick</u> (please read guidance note 2)		Indoors	<input type="checkbox"/>
					Outdoors	<input type="checkbox"/>
Day	Start	Finish	<u>Please give further details here</u> (please read guidance note 3)			
Mon						
Tue			<u>State any seasonal variations for the exhibition of films</u> (please read guidance note 4)			
Wed						
Thur			<u>Non standard timings. Where you intend to use the premises for the exhibition of films at different times to those listed in the column on the left, please list</u> (please read guidance note 5)			
Fri						
Sat						
Sun						

C

Indoor sporting events Standard days and timings (please read guidance note 6)			<u>Please give further details</u> (please read guidance note 3)
Day	Start	Finish	
Mon			
Tue			<u>State any seasonal variations for indoor sporting events</u> (please read guidance note 4)
Wed			
Thur			<u>Non standard timings. Where you intend to use the premises for indoor sporting events at different times to those listed in the column on the left, please list</u> (please read guidance note 5)
Fri			
Sat			
Sun			

D

Boxing or wrestling entertainments Standard days and timings (please read guidance note 6)			<u>Will the boxing or wrestling entertainment take place indoors or outdoors or both – please tick</u> (please read guidance note 2)	Indoors	<input type="checkbox"/>
				Outdoors	<input type="checkbox"/>
				Both	<input type="checkbox"/>
Day	Start	Finish	<u>Please give further details here</u> (please read guidance note 3)		
Mon					
Tue					
Wed			<u>State any seasonal variations for boxing or wrestling entertainment</u> (please read guidance note 4)		
Thur					
Fri			<u>Non standard timings. Where you intend to use the premises for boxing or wrestling entertainment at different times to those listed in the column on the left, please list</u> (please read guidance note 5)		
Sat					
Sun					

E

Live music Standard days and timings (please read guidance note 6)			<u>Will the performance of live music take place indoors or outdoors or both – please tick</u> (please read guidance note 2)	Indoors	<input type="checkbox"/>			
				Outdoors	<input type="checkbox"/>			
				Both	<input type="checkbox"/>			
Day	Start	Finish	<u>Please give further details here</u> (please read guidance note 3)					
Mon								
Tue								
Wed						<u>State any seasonal variations for the performance of live music</u> (please read guidance note 4)		
Thur								
Fri						<u>Non standard timings. Where you intend to use the premises for the performance of live music at different times to those listed in the column on the left, please list</u> (please read guidance note 5)		
Sat								
Sun								

F

Recorded music Standard days and timings (please read guidance note 6)			<u>Will the playing of recorded music take place indoors or outdoors or both – please tick</u> (please read guidance note 2)	Indoors	<input type="checkbox"/>
				Outdoors	<input type="checkbox"/>
				Both	<input type="checkbox"/>
Day	Start	Finish	<u>Please give further details here</u> (please read guidance note 3) Provision of recorded music, through the premises internal sound system, provision of Juke box, karaoke etc <u>State any seasonal variations for the playing of recorded music</u> (please read guidance note 4) <u>Non standard timings. Where you intend to use the premises for the playing of recorded music at different times to those listed in the column on the left, please list</u> (please read guidance note 5)		
Mon					
Tue					
Wed					
Thur					
Fri					
Sat					
Sun					

G

Performances of dance Standard days and timings (please read guidance note 6)			<u>Will the performance of dance take place indoors or outdoors or both – please tick</u> (please read guidance note 2)	Indoors	<input type="checkbox"/>
				Outdoors	<input type="checkbox"/>
				Both	<input type="checkbox"/>
Day	Start	Finish	<u>Please give further details here</u> (please read guidance note 3)		
Mon					
Tue			<u>State any seasonal variations for the performance of dance</u> (please read guidance note 4)		
Wed					
Thur			<u>Non standard timings. Where you intend to use the premises for the performance of dance at different times to those listed in the column on the left, please list</u> (please read guidance note 5)		
Fri					
Sat					
Sun					

H

Anything of a similar description to that falling within (e), (f) or (g) Standard days and timings (please read guidance note 6)			<u>Please give a description of the type of entertainment you will be providing</u>		
Day	Start	Finish	<u>Will this entertainment take place indoors or outdoors or both – please tick</u> (please read guidance note 2)	Indoors	<input type="checkbox"/>
Mon				Outdoors	<input type="checkbox"/>
				Both	<input type="checkbox"/>
Tue			<u>Please give further details here</u> (please read guidance note 3)		
Wed					
Thur			<u>State any seasonal variations for entertainment of a similar description to that falling within (e), (f) or (g)</u> (please read guidance note 4)		
Fri					
Sat			<u>Non standard timings. Where you intend to use the premises for the entertainment of a similar description to that falling within (e), (f) or (g) at different times to those listed in the column on the left, please list</u> (please read guidance note 5)		
Sun					

Provision of facilities for making music Standard days and timings (please read guidance note 6)			<u>Please give a description of the facilities for making music you will be providing</u>			
			<u>Will the facilities for making music be indoors or outdoors or both – please tick</u> (please read guidance note 2)		Indoors <input type="checkbox"/> Outdoors <input type="checkbox"/> Both <input type="checkbox"/>	
Day	Start	Finish	<u>Please give further details here</u> (please read guidance note 3)			
Mon						
Tue						
Wed					<u>State any seasonal variations for the provision of facilities for making music</u> (please read guidance note 4)	
Thur						
Fri					<u>Non standard timings. Where you intend to use the premises for provision of facilities for making music at different times to those listed in the column on the left, please list</u> (please read guidance note 5)	
Sat						
Sun						

J

Provision of facilities for dancing Standard days and timings (please read guidance note 6)			<u>Will the facilities for dancing be indoors or outdoors or both – please tick</u> (see guidance note 2)	Indoors <input type="checkbox"/>
				Outdoors <input type="checkbox"/>
				Both <input type="checkbox"/>
			<u>Please give a description of the facilities for dancing you will be providing</u>	
Day	Start	Finish		
Mon			<u>Please give further details here</u> (please read guidance note 3)	
Tue				
Wed			<u>State any seasonal variations for providing dancing facilities</u> (please read guidance note 4)	
Thur				
Fri			<u>Non standard timings. Where you intend to use the premises for the provision of facilities for dancing at different times to those listed in the column on the left, please list</u> (please read guidance note 5)	
Sat				
Sun				

K

Provision of facilities for entertainment of a similar description to that falling within i or j Standard days and timings (please read guidance note 6)			<u>Please give a description of the type of entertainment facility you will be providing</u>		
Day	Start	Finish	<u>Will the entertainment facility be indoors or outdoors or both – please tick</u> (please read guidance note 2)	Indoors	<input type="checkbox"/>
Mon				Outdoors	<input type="checkbox"/>
				Both	<input type="checkbox"/>
Tue			<u>Please give further details here</u> (please read guidance note 3)		
Wed					
Thur			<u>State any seasonal variations for the provision of facilities for entertainment of a similar description to that falling within i or j</u> (please read guidance note 4)		
Fri					
Sat			<u>Non standard timings. Where you intend to use the premises for the provision of facilities for entertainment of a similar description to that falling within i or j at different times to those listed in the column on the left, please list</u> (please read guidance note 5)		
Sun					

L

Late night refreshment Standard days and timings (please read guidance note 6)			<u>Will the provision of late night refreshment take place indoors or outdoors or both – please tick</u> (please read guidance note 2)	Indoors	<input type="checkbox"/>
				Outdoors	<input type="checkbox"/>
				Both	<input type="checkbox"/>
Day	Start	Finish	<u>Please give further details here</u> (please read guidance note 3)		
Mon					
Tue					
Wed			<u>State any seasonal variations for the provision of late night refreshment</u> (please read guidance note 4)		
Thur					
Fri			<u>Non standard timings. Where you intend to use the premises for the provision of late night refreshment at different times, to those listed in the column on the left, please list</u> (please read guidance note 5)		
Sat					
Sun					

M

Supply of alcohol Standard days and timings (please read guidance note 6)			Will the supply of alcohol be for consumption (Please tick box) (please read guidance note 7)	On the premises	<input type="checkbox"/>
				Off the premises	<input type="checkbox"/>
				Both	<input type="checkbox"/>
Day	Start	Finish	State any seasonal variations for the supply of alcohol (please read guidance note 4)		
Mon					
Tue					
Wed					
Thur					
Fri					
Sat					
Sun					
			Non-standard timings. Where you intend to use the premises for the supply of alcohol at different times to those listed in the column on the left, please list (please read guidance note 5)		

N

Please highlight any adult entertainment or services, activities, other entertainment or matters ancillary to the use of the premises that may give rise to concern in respect of children (please read guidance note 8)

The premises operate as a Casino

O

Hours premises are open to the public Standard days and timings (please read guidance note 6)			<u>State any seasonal variations</u> (please read guidance note 4)
Day	Start	Finish	
Mon	00:00	00:00	<u>Non standard timings. Where you intend the premises to be open to the public at different times from those listed in the column on the left, please list</u> (please read guidance note 5)
Tue	00:00	00:00	
Wed	00:00	00:00	
Thur	00:00	00:00	
Fri	00:00	00:00	
Sat	00:00	00:00	
Sun	00:00	00:00	

Please identify those conditions currently imposed on the licence which you believe could be removed as a consequence of the proposed variation you are seeking
 The following condition shall be removed:-

"Annex 2

2. All activities permitted by this Licence shall take place inside the Licensed Premises"

Please tick yes

- I have enclosed the premises licence
- I have enclosed the relevant part of the premises licence

If you have not ticked one of these boxes please fill in reasons for not including the licence, or part of it, below

Reasons why I have failed to enclose the premises licence or relevant part of premises licence

P Describe any additional steps you intend to take to promote the four licensing objectives as a result of the proposed variation:

a) General – all four licensing objectives (b,c,d,e) (please read guidance note 9)

The premises are an established casino and save as set out below in respect of the external area there are no additional amendments proposed to the operating Schedule to this Licence.

b) The prevention of crime and disorder

N/A

c) Public safety

1. When the external area is in use for the provision of licensable activities, members of staff shall regularly monitor the external area to ensure that empty glasses, bottles and other drinking recepticals are cleared away promptly.

d) The prevention of public nuisance

1. The external area shown on the Premises Licence Plan shall only be licensed for the sale/supply of alcohol and provision of late night refreshment.

2. The provision of licensable activities in the external area shown on the Premises Licence Plan shall only be permitted between 08:00am and 02:00am.

3. When the external area shown on the Premises Licence Plan is in use for the provision of licensable activities after 22:00pm members of staff shall regularly monitor the area to ensure that no nuisance is caused to any nearby residential premises by customers using that area.

e) The protection of children from harm

N/A

Please tick yes

- I have made or enclosed payment of the fee
- I have sent copies of this application and the plan to responsible authorities and others where applicable
- I understand that I must now advertise my application
- I have enclosed the premises licence or relevant part of it or explanation
- I understand that if I do not comply with the above requirements my application will be rejected

IT IS AN OFFENCE, LIABLE ON CONVICTION TO A FINE UP TO LEVEL 5 ON THE STANDARD SCALE, UNDER SECTION 158 OF THE LICENSING ACT 2003 TO MAKE A FALSE STATEMENT IN OR IN CONNECTION WITH THIS APPLICATION

Part 5 – Signatures (please read guidance note 10)

Signature of applicant (the current premises licence holder) or applicant’s solicitor or other duly authorised agent (please read guidance note 11). **If signing on behalf of the applicant please state in what capacity.**

Signature	[Redacted]
Date	10/09/2013
Capacity	Duly Authorised Solicitor

Where the premises licence is jointly held signature of 2nd applicant (the current premises licence holder) or 2nd applicant’s solicitor or other authorised agent (please read guidance note 12). **If signing on behalf of the applicant please state in what capacity.**

Signature	
Date	
Capacity	

Contact name (where not previously given) and address for correspondence associated with this application (please read guidance note 13)

David N Roberts
Eversheds LLP
70 Great Bridgewater Street
#4620915

Post town	Manchester	Post code	M1 5ES
------------------	------------	------------------	--------

Telephone number (if any)	0845 497 8146
----------------------------------	---------------

If you would prefer us to correspond with you by e-mail your e-mail address (optional) davidnroberts@eversheds.com
--

Notes for Guidance

This application cannot be used to vary the licence so as to extend the period for which the licence has effect or to vary substantially the premises to which it relates. If you wish to make that type of change to the premises licence you should make a new premises licence application under section 17 of the Licensing Act 2003.

1. Describe the premises. For example the type of premises, its general situation and layout and any other information which could be relevant to the licensing objectives. Where your application includes off-supplies of alcohol and you intend to provide a place for consumption of these off-supplies you must include a description of where the place will be and its proximity to the premises.
2. Where taking place in a building or other structure please tick as appropriate. Indoors may include a tent.
3. For example state type of activity to be authorised, if not already stated, and give relevant further details, for example (but not exclusively) whether or not music will be amplified or unamplified.
4. For example (but not exclusively), where the activity will occur on additional days during the summer months.
5. For example (but not exclusively), where you wish the activity to go on longer on a particular day e.g. Christmas Eve.
6. Please give timings in 24 hour clock (e.g. 16:00) and only give details for the days of the week when you intend the premises to be used for the activity.
7. If you wish people to be able to consume alcohol on the premises please tick on, if you wish people to be able to purchase alcohol to consume away from the premises please tick off. If you wish people to be able to do both please tick both.
8. Please give information about anything intended to occur at the premises or ancillary to the use of the premises which may give rise to concern in respect of children regardless of whether you intend children to have access to the premises, for example (but not exclusively) nudity or semi-nudity, films for restricted age groups, the presence of gaming machines.
9. Please list here steps you will take to promote all four licensing objectives together.
10. The application form must be signed.
11. An applicant's agent (for example solicitor) may sign the form on their behalf provided that they have actual authority to do so.
12. Where there is more than one applicant, both applicants or their respective agents must sign the application form.
13. This is the address which we shall use to correspond with you about this application.

All dimensions to be checked on site prior to work commencing on site. Any discrepancies must be reported to MR+P
 All dimensions to be checked on site prior to work commencing as this property has not been surveyed by MR+P. Any discrepancies must be reported to MR+P

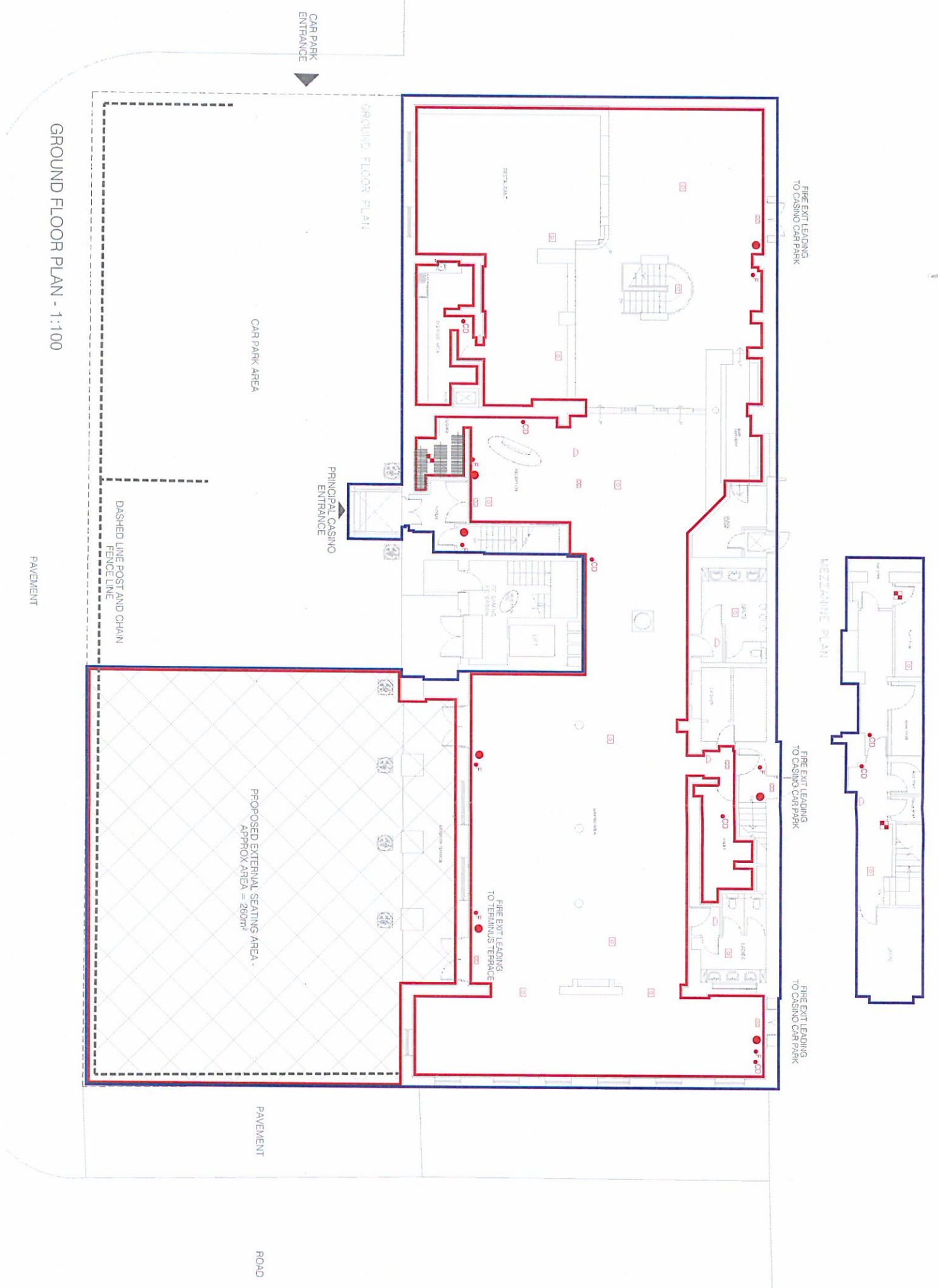
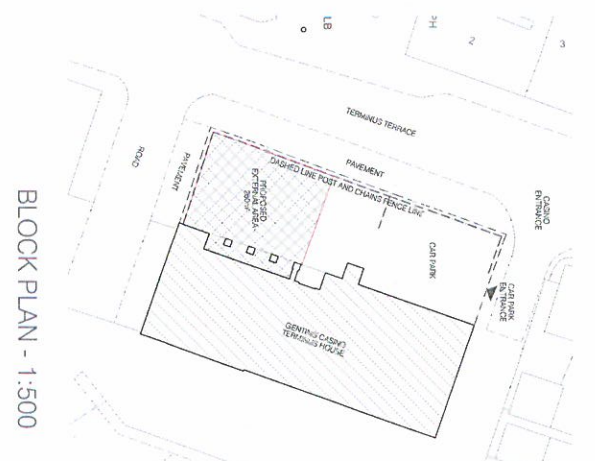

- KEY**
- PROPERTY DEMISE
 - Extent of boundary / perimeter of the premises.
- PROPERTY DEMISE**
- Basement = 210m²
 - Ground Floor = 857m²
 - Mezzanine = 56.2m²
 - Total = 1123.2m²
- Extent of boundary / perimeter of the premises.**
- Sale and supply of alcohol
 - Provision of late night refreshment
 - Provision for regulated entertainment
 - Provision for entertainment facilities
- Basement = 0m²**
- Ground Floor = 463.2m²
 - Mezzanine Floor = 0m²
 - External Area = 260m²
 - Total = 723.2m²

- Break glass
- Heat detector unit
- Smoke detector unit
- Light & buzzer unit
- Sounder unit
- Water extinguisher
- Carbon Dioxide extinguisher
- Foam extinguisher
- Powder extinguisher
- Fire blanket
- Hose reel
- Illuminated exit sign

RECEIVED
12 SEP 2013



MR+P
ARCHITECTS

MELLING ROADWAY + PARTNERS LTD
 CHARTER HOUSE MOORE STREET
 SHEPHERD SQUARE
 LONDON E1 7JL
 T: 0114 2723321
 F: 0114 2727395
 E: info@mrp-architects.co.uk

PROJECT
 GENTING CLUB SOUTHAMPTON
 TERMINUS HOUSE
 TERMINUS TERRACE, SOUTHAMPTON
 SO14 3FE

TITLE
 BASEMENT GROUND AND MEZZANINE PLANS

DRAWING STATUS
 LICENCE DRAWING

DRAWN BY: DL
 DATE: AUGUST 2013
 SCALE: 1:100@A1
 DRAWING NO: 5154/601



HAMPSHIRE CONSTABULARY



NEW GRANT OR VARIATION OF PREMISES LICENCE OR CLUB PREMISES CERTIFICATE FORM FOR REPRESENTATIONS FROM HAMPSHIRE CONSTABULARY

Before completing this form please read the guidance notes on page 3.
Once completed please send your representation form to your local Licensing Authority.
You must keep a copy of the completed form for police records.

**Hampshire Constabulary wish to make a representation(s) regarding the grant or variation of a Premises Licence or Club Premises Certificate issued under the Licensing Act 2003.
These representations must be made within 28 days**

Postal address of premises or club premises:			
Genting Club Terminus House Terminus Terrace			
Post town:	Southampton	Postcode:	SO14 3FE

Name of premises licence holder or club holding club premises certificate (if known)
Genting Casinos Uk Limited

Police Details

Hampshire Constabulary is a responsible authority.

Name and address:
PC 21071 NORRIS Southampton Central Police Station Southern Road Southampton SO15 1AN

This application to object relates to the following licensing objective(s)

- 1) The prevention of crime and disorder
- 2) Public safety
- 3) The prevention of public nuisance
- 4) The protection of children from harm

Please select one or more boxes





HAMPSHIRE CONSTABULARY



NEW GRANT OR VARIATION OF PREMISES LICENCE OR CLUB PREMISES CERTIFICATE FORM FOR REPRESENTATIONS FROM HAMPSHIRE CONSTABULARY

State the ground(s) for representation *(please read guidance notes 1 & 2)*

On behalf of the Chief Officer of Police, I am writing to lodge a representation of the above application on the following grounds:

- 1) The prevention of Crime and Disorder
- 2) Public Safety
- 3) The prevention of Public Nuisance.

The police have concerns over the application which are detailed below.

The applicants are requesting to extend the area licensed for the sale of alcohol and late night refreshments into the external area at the front of the premises from 08 00hrs to 02 00hrs(appendix A) and if granted the removal of the existing condition stating "all activities permitted by this licence shall take place inside the Licensed Premises". The police have been in discussions with the applicants discussing the implementation of two conditions and agreeing hours for the external area of Mon to Wed 08 00 to 01 00hrs, Thurs, Fri and Sat 08 00hrs to 01 30hrs and Sunday 08 00hrs to 00 30hrs. The premises is in an area with a high amount of assorted public houses and restaurants and also many residential properties. The application has been submitted in order that the venue can try and increase their trade and compete with the neighbouring businesses by allowing customers to benefit from sitting outside for a meal or a drink in clement weather which they cannot currently offer. The police have concerns that without conditions in place there could be an increase in crime and disorder and public nuisance caused by patrons being in drink and or making excessive noise. This could impact on members of the public passing by or the nearby residents.

There is a cctv condition currently in place however we are just requesting that a more up to date condition is applied to the licence. Theoretically there is going to be an increase in trade which in turn increases the likelihood of crime and disorder. The premises currently only has to secure footage of the reception area for 31 days. We are requesting that if any incidents take place which are recorded at the venue any footage of that incident will be backed up and retained. Any footage other than in the reception area is only secured for 7 days.

There is currently only one nearby venue which still has tables and chairs outside in the early hours of the morning and we have requested that the venue adjust the requested opening hours to ensure that there is no real increase to nearby residents caused by noise. The venue currently have a 24 hour licence so they are still able to supply alcohol and late night refreshments to their patrons however this will need to take place within the venue. I do not feel it necessary for patrons to be outside the venue until 02 00hrs and the slight amendment to the requested hours should have no real impact on them. Unfortunately we have not managed to come to an agreement in the time allowed and so





HAMPSHIRE CONSTABULARY



NEW GRANT OR VARIATION OF PREMISES LICENCE OR CLUB PREMISES CERTIFICATE FORM FOR REPRESENTATIONS FROM HAMPSHIRE CONSTABULARY

respectfully request that the committee make the decision with regards to the variation.

State any conditions that the Police seek to negate the need for a hearing

Outside Checks

The Designated Premises Supervisor shall ensure that any patrons using the outside licensed area at the front of the premises after 22 00hrs do so in an orderly manner and are supervised by staff so as to ensure that there is no public nuisance. Checks are to be made at 30 minute intervals and records are to be made and should be available for inspection by Hampshire Constabulary and any responsible authority. The records should be retained for a period of 3 months.

CCTV

The premises shall have sufficient cameras located within the premises to cover all public areas including outside of the premises covering the entrance and exit. The system will be able to cope with strobe lighting (where used) and all levels of illumination throughout the premises as well as outside areas.

CCTV warning signs to be fitted in public places.

The CCTV system must be operating at all times whilst the premises are open for licensable activity. All equipment shall have a constant and accurate time and date generation.

The recording system will be able to capture a minimum of 4 frames per second and the recordings of the reception area shall be kept for a minimum of 28 days.

Records must be made on a weekly basis and kept for inspection to show that the system is functioning correctly and that data is being securely retained.

The DPS or premises manager must be able to demonstrate that the CCTV system has measures to prevent recordings being tampered with, i.e. password protected.

There shall be sufficient members of trained staff at the premises during operating hours to be able to provide viewable copies immediately to police on request when investigating allegations of offences or criminal activity. Any images recovered must be in a viewable format on either disc or VHS. Footage supplied in a digital format on CD or DVD will also have a copy of the CCTV system software enabled on the disc to allow playback.

In the event of technical failure of the CCTV equipment the Premises Licence holder/DPS MUST





HAMPSHIRE CONSTABULARY



NEW GRANT OR VARIATION OF PREMISES LICENCE OR CLUB PREMISES CERTIFICATE FORM FOR REPRESENTATIONS FROM HAMPSHIRE CONSTABULARY

report the failure to the Hampshire Western Police Licensing Unit within 24 hours.

Where a record is made of any incident at the premises the licence holder will ensure that any footage from the premises CCTV system covering the incident is backed up and retained for 12 months.

IT IS AN OFFENCE, UNDER SECTION 158 OF THE LICENSING ACT 2003 TO MAKE A FALSE STATEMENT IN OR IN CONNECTION WITH THIS REPRESENTATION

Part 3 – Signatures (please read guidance note 3)

Recommendation of Police Officer

Signature of Police Officer Completing

Signature:

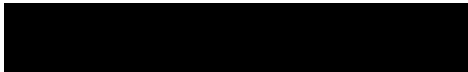

PC 21071

Date:

10/10/13

Recommendation of Police Sergeant

Signature of Police Sergeant





HAMPSHIRE CONSTABULARY



**NEW GRANT OR VARIATION OF PREMISES LICENCE
OR CLUB PREMISES CERTIFICATE
FORM FOR REPRESENTATIONS FROM HAMPSHIRE CONSTABULARY**

Signature:

[Handwritten signature]

Date:

10/10/13

Decision of Police Licensing Inspector

[Empty box for decision]

Signature of Police Licensing Inspector

Signature:

Date:

NOTES FOR GUIDANCE

- 1. The ground(s) for representation must be based on one of the licensing objectives.
- 2. Please list any additional information or details, for example dates of problems which are included in the grounds for representation if available.
- 3. The representation form must be signed.



From: Montague, Hayley on behalf of Licensing
Sent: 01 October 2013 20:54
To: [REDACTED]
Subject: RE: objection to Application to vary a premises License - Genting Club

Attachments: ufm2.doc

Dear Mr. Riley,

Please find attached an acknowledgement letter regarding your below representation.

Kind regards,

Hayley Montague
Licensing Enforcement Officer
Legal, HR and Democratic Services
Southampton and Eastleigh Licensing Partnership
Southampton City Council

Tele: 023 8083 2421
Fax: 023 8083 4061
E-mail: hayley.montague@southampton.gov.uk
Web: www.southampton.gov.uk/licensing
Post: Licensing - Southampton City Council
PO Box 1767, Southampton. SO18 9LA

Please note:- This email is confidential but may have to be disclosed under the Freedom of Information Act 2000, the Data Protection Act 1998 or the Environmental Information Regulations 2004. SCC does not make legally binding agreements or accept formal notices/proceedings by email. Emails may be monitored. This e-mail (and its attachments) is intended only for the use of the person(s) to whom it is addressed and may contain information which is privileged and/or confidential. If it has come to you in error you must take no action based on it, nor must you copy or show it to anyone.

From: [REDACTED]
Sent: 01 October 2013 15:17
To: Licensing
Subject: objection to Application to vary a premises License - Genting Club

Dear Sirs

I would like to object to the application – to extend the licence into an external area to the front of the premises to permit the sale of alcohol and the provision of late night refreshment

I expect that this application is to serve into the early hours of the morning, which will increase the already high volume of noise that their customers make when leaving the premises at any time of the night right down to 6am.

It is a partially residential area who put up with a great deal that comes out of the Casino. The noise levels around the area do seem to stem from the casino's late night visitors

It will also have an impact on the traffic/parking in the area as the proposed site is already used as a car park and is always full until the early hours.

Coupled with the proposed plan to get rid of some parking on Terminus terrace for a taxi rank is going to make the area intolerable to live on

David Riley
2 Terminus Terrace
Southampton
SO14 3DT
02380 710652

2000, the Data Protection Act 1998 or the Environmental Information Regulations 2004. SCC does not make legally binding agreements or accept formal notices/proceedings by email. Emails may be monitored. This e-mail (and its attachments) is intended only for the use of the person(s) to whom it is addressed and may contain information which is privileged and/or confidential. If it has come to you in error you must take no action based on it, nor must you copy or show it to anyone.

From: Residents Association South Western House [REDACTED]

Sent: 07 October 2013 19:07

To: Licensing

Subject: Casino at Terminus Terrace Application

Dear Sir

I am writing on behalf of the residents of South Western House, as a director of the RTM Co Ltd.. Our building, with 110 apartments, is adjacent to the Genting Club and we are already having to contend with a huge amount of noise pollution from all the restaurants, clubs and pubs around the top end of Oxford Street. In addition, our private parking spaces are constantly being compromised by unauthorised vehicles whose drivers are looking for free and convenient parking. As such, I strongly object to the application to use half the casino's carpark for seating with a licence to sell alcohol and refreshments outside until 2am as I feel this will add greatly to the problems outlined above.

Please ignore an earlier e-mail which came from my icloud account - I was still amending it when I inadvertently touched the send button. Many apologies.

Yours faithfully

Sonja Angus

For SWH RTM Co Ltd

From: Sonja Angus [REDACTED]
Sent: 08 October 2013 20:22
To: Licensing
Subject: RE: Casino at Terminus Terrace Application
Dear Hayley

My address is 108 Imperial Apartments, South Western House, Southampton, SO14 3AL.

Thank you for pointing that out.

Kind regards

Sonja Angus

For SWH RTM Co Ltd

Licensing <Licensing@southampton.gov.uk> wrote:

Dear Ms. Angus,

As required by the Licensing Act 2003 please provide your address so that we can validate your below representation.

I note that you are also writing on behalf of the residents of South Western House, in order to accept the representation as being on their behalf please provide the names and addresses of those whom you represent and their consent to being represented by you. Further information on representations can be found on our web pages, available via the following link:

<http://www.southampton.gov.uk/business/licensing/alcohol-licences/representations.aspx>.

Kind regards,

Hayley Montague

Licensing Enforcement Officer

Legal, HR and Democratic Services

Southampton and Eastleigh Licensing Partnership

Southampton City Council

Tele: 023 8083 2421

Fax: 023 8083 4061

E-mail: hayley.montague@southampton.gov.uk

Web: www.southampton.gov.uk/licensing

Post: Licensing - Southampton City Council

PO Box 1767, Southampton. SO18 9LA

Please note:- This email is confidential but may have to be disclosed under the Freedom of Information Act