

Reference: 2014/00918/01SPRN

Hearing:

24<sup>th</sup> April 2014

### Application for Premises Licence

Premises Name: Sula's Greek Cafe  
 Premises Address: 116A Portswood Road  
 Southampton  
 SO17 2FY

Application Date: 5th March 2014  
 Application Received Date: 5th March 2014

Application Valid Date: 5th March 2014

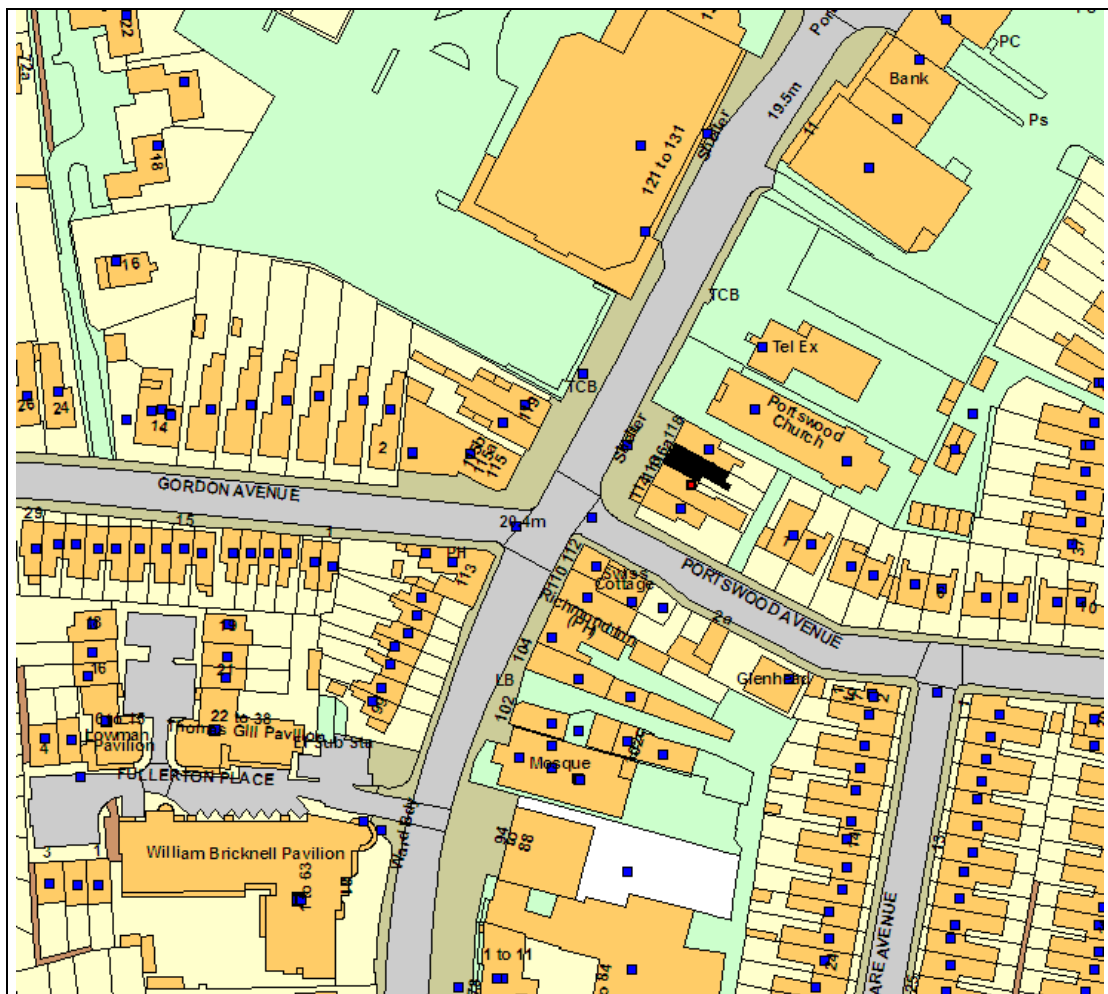

This map is reproduced from Ordnance Survey material with the permission of Ordnance Survey on behalf of the Controller of Her Majesty's Stationery Office © Crown copyright. Unauthorised reproduction infringes Crown copyright and may lead to prosecution or civil proceedings. Southampton City Council Licence No. 100019679 2007.

## ***Representation From Responsible Authorities***

<b>Responsible Authority</b>	<b>Satisfactory?</b>	<b>Comments</b>
Child Protection Services - Licensing	No response received	
Hampshire Fire And Rescue - Licensing	Yes	
Environmental Health - Licensing	No	See attached representation
Primary Care Trust - Public Health Manager	No response received	
Planning & Sustainability - Development Control - Licensing	No response received	
Police - Licensing	Yes	Conditions agreed with applicant
Trading Standards - Licensing	Yes	

## ***Other Representations***

<b>Name</b>	<b>Address</b>	<b>Contributor Type</b>
None		

## ***Legal Implications***

1. The Licensing Act 2003 specifically restricts the grounds on which the Council, as Licensing Authority (LA), may refuse an application for a new Premises Licence, or impose conditions. Where relevant representations are made, the LA may refuse on the grounds that the licensing objectives are not met or the operating schedule is inadequate. Equally, conditions may be imposed where relevant and necessary. The LA may also refuse an application in part and thereby only permit some of the licensable activities sought.
2. The decision making committee, in considering an application, must have regard to the adopted Statement of Licensing Policy and any relevant representations made by those directly affected.
3. An applicant for a new Premises Licence whose application has been refused, or who is aggrieved by conditions imposed, may appeal against the decision to the Magistrates' Court.
4. In considering this application the committee will sit in a quasi-judicial capacity and is thus obliged to consider applications in accordance with both the Licensing Act 2003 (Hearings) Regulations 2005, and amending secondary legislation and the rules of natural justice. The practical effect of this is that the committee must make its decision based on evidence submitted in accordance with the legislation and give adequate reasons for reaching its decision.

The committee must also have regards to:-

5. *Crime and Disorder Act 1998*  
Section 17 of the Crime and Disorder Act 1998 places the Council under a duty to exercise its various functions with due regard to the likely effect of the exercise of those functions on, and the need to do all that it reasonably can to prevent, crime and disorder in its area.
6. *Human Rights Act 1998*  
The Act requires UK legislation to be interpreted in a manner consistent with the European Convention on Human Rights. It is unlawful for the Council to act in a way that is incompatible (or fail to act in a way that is compatible) with the rights protected by the Act. Any action undertaken by the Council that could have an effect upon another person's Human Rights must be taken having regard to the principle of Proportionality - the need to balance the rights of the individual with the rights of the community as a whole. Any action taken by the Council which affect another's rights must be no more onerous than is necessary in a democratic society. The matter set out in this report must be considered in light of the above obligations.

**Application for a premises licence to be granted  
under the Licensing Act 2003**

---

**PLEASE READ THE FOLLOWING INSTRUCTIONS FIRST**

Before completing this form please read the guidance notes at the end of the form  
If you are completing this form by hand please write legibly in block capitals. In all cases ensure that your answers are inside the boxes and written in black ink. Use additional sheets if necessary.  
You may wish to keep a copy of the completed form for your records.

**I/We**

**apply for a premises licence under section 17 of the Licensing Act 2003 for the premises described in Part 1 below (the premises) and I/we are making this application to you as the relevant licensing authority in accordance with section 12 of the Licensing Act 2003.**

**Part 1 – Premises details**

Postal address of premises or, if none, ordnance survey map reference or description	
Post town	Post code

Telephone number at premises (if any)

Non-domestic rateable value of premises

£ <input style="width: 90%; height: 25px;" type="text"/>
--

**Part 2 - Applicant details**

Please state whether you are applying for a premises licence as

Please tick  yes

- |    |   |                          |                             |
|----|---|--------------------------|-----------------------------|
| a) | an individual or individuals*                   | <input type="checkbox"/> | please complete section (A) |
| b) | a person other than an individual*              |                          |                             |
|    | i. as a limited company                         | <input type="checkbox"/> | please complete section (B) |
|    | ii. as a partnership                            | <input type="checkbox"/> | please complete section (B) |
|    | iii. as an unincorporated association or        | <input type="checkbox"/> | please complete section (B) |
|    | iv. other (for example a statutory corporation) | <input type="checkbox"/> | please complete section (B) |
| c) | a recognised club                               | <input type="checkbox"/> | please complete section (B) |
| d) | a charity                                       | <input type="checkbox"/> | please complete section (B) |

- e) the proprietor of an educational establishment  please complete section (B)
- f) a health service body  please complete section (B)
- g) a person who is registered under Part 2 of the Care Standards Act 2000 (c14) in respect of an independent hospital  please complete section (B)
- h) the chief officer of police of a police force in England and Wales  please complete section (B)

\*If you are applying as a person described in (a) or (b) please confirm:

Please tick  yes

- I am carrying on or proposing to carry on a business which involves the use of the premises for licensable activities; or
- I am making the application pursuant to a
  - statutory function or
  - a function discharged by virtue of Her Majesty's prerogative

**(A) INDIVIDUAL APPLICANTS** (fill in as applicable)

Mr  Mrs  Miss  Ms  Other

Surname

First names

Please tick  yes

I am 18 years old or over

Current address if different from premises address

Post Town  Postcode

Daytime contact telephone number

E-mail address (optional)

**SECOND INDIVIDUAL APPLICANT (IF APPLICABLE)**

Mr  Mrs  Miss  Ms  Other

Surname  First names

Please tick  yes

I am 18 years old or over

Current address if different from premises address

Post Town  Postcode

Daytime contact telephone number

E-mail address (optional)

**(B) OTHER APPLICANTS**

Please provide name and registered address of applicant in full. Where appropriate please give any registered number. In the case of a partnership or other joint venture (other than a body corporate), please give the name and address of each party concerned

Name
Address
Registered number (where applicable)
Description of applicant (for example partnership, company, unincorporated association etc)
Telephone number (if any)
E-mail address (optional)

### Part 3 Operating Schedule

When do you want the premises licence to start?

If you wish the licence to be valid only for a limited period, when do you want it to end?

If 5,000 or more people are expected to attend the premises at any one time, please state the number expected to attend.

Please give a general description of the premises (please read guidance note1)

What licensable activities do you intend to carry on from the premises?  
(Please see sections 1 and 14 of the Licensing Act 2003 and Schedule 1 and 2 to the Licensing Act 2003)

Please tick  yes

**Provision of regulated entertainment**

- a) plays (if ticking yes, fill in box A)
- b) films (if ticking yes, fill in box B)
- c) indoor sporting events (if ticking yes, fill in box C)
- d) boxing or wrestling entertainment (if ticking yes, fill in box D)
- e) live music (if ticking yes, fill in box E)
- f) recorded music (if ticking yes, fill in box F)
- g) performances of dance (if ticking yes, fill in box G)
- h) anything of a similar description to that falling within (e), (f) or (g)  
(if ticking yes, fill in box H)

**Provision of entertainment facilities for:**

- i) making music (if ticking yes, fill in box I)
- j) dancing (if ticking yes, fill in box J)
- k) entertainment of a similar description to that falling within (i) or (j)  
(if ticking yes, fill in box K)

**Provision of late night refreshment** (if ticking yes, fill in box L)

**Supply of alcohol** (if ticking yes, fill in box M)

**In all cases complete boxes N, O and P**



# A

<b>Plays</b> Standard days and timings (please read guidance note 6)			<b>Will the performance of a play take place indoors or outdoors or both – please tick <input checked="" type="checkbox"/> (please read guidance note 2)</b>	Indoors	
Day	Start	Finish		Outdoors	
				Both	
Mon			<b>Please give further details here</b> (please read guidance note 3)		
Tue					
Wed			<b>State any seasonal variations for performing plays</b> (please read guidance note 4)		
Thur					
Fri			<b>Non standard timings. Where you intend to use the premises for the performance of plays at different times to those listed in the column on the left, please list</b> (please read guidance note 5)		
Sat					
Sun					

# B

<b>Films</b> Standard days and timings (please read guidance note 6)			<b>Will the exhibition of films take place indoors or outdoors or both – please tick <input checked="" type="checkbox"/> (please read guidance note 2)</b>	Indoors	
Day	Start	Finish		Outdoors	
				Both	
Mon			<b>Please give further details here</b> (please read guidance note 3)		
Tue					
Wed			<b>State any seasonal variations for the exhibition of films</b> (please read guidance note 4)		
Thur					
Fri			<b>Non standard timings. Where you intend to use the premises for the exhibition of films at different times to those listed in the column on the left, please list</b> (please read guidance note 5)		
Sat					
Sun					

## C

<b>Indoor sporting events</b> Standard days and timings (please read guidance note 6)			<b>Please give further details</b> (please read guidance note 3)
Day	Start	Finish	
Mon			
Tue			
Wed			
Thur			
Fri			
Sat			
Sun			
			<b>State any seasonal variations for indoor sporting events</b> (please read guidance note 4)
			<b>Non standard timings. Where you intend to use the premises for indoor sporting events at different times to those listed in the column on the left, please list</b> (please read guidance note 5)

## D

<b>Boxing or wrestling entertainments</b> Standard days and timings (please read guidance note 6)			<b>Will the boxing or wrestling entertainment take place indoors or outdoors or both – please tick <input checked="" type="checkbox"/></b> (please read guidance note 2).			
Day	Start	Finish			Indoors	
Mon			Outdoors			
Tue			Both			
Wed			<b>Please give further details here</b> (please read guidance note 3)			
Thur						
Fri						
Sat						
Sun						
					<b>State any seasonal variations for boxing or wrestling entertainment</b> (please read guidance note 4)	
					<b>Non standard timings. Where you intend to use the premises for boxing or wrestling entertainment at different times to those listed in the column on the left, please list</b> (please read guidance note 5)	

## E

<b>Live music</b> Standard days and timings (please read guidance note 6)			<b>Will the performance of live music take place indoors or outdoors or both – please tick <input checked="" type="checkbox"/> (please read guidance note 2)</b>	Indoors	
Day	Start	Finish		Outdoors	
Mon			<b>Please give further details here</b> (please read guidance note 3)	Both	
Tue					
Wed					
Thur			<b>State any seasonal variations for the performance of live music</b> (please read guidance note 4)		
Fri					
Sat			<b>Non standard timings. Where you intend to use the premises for the performance of live music at different times to those listed in the column on the left, please list</b> (please read guidance note 5)		
Sun					

## F

<b>Recorded music</b> Standard days and timings (please read guidance note 6)			<b>Will the playing of recorded music take place indoors or outdoors or both – please tick <input checked="" type="checkbox"/> (please read guidance note 2)</b>	Indoors	
Day	Start	Finish		Outdoors	
Mon			<b>Please give further details here</b> (please read guidance note 3)	Both	
Tue					
Wed					
Thur			<b>State any seasonal variations for playing recorded music</b> (please read guidance note 4)		
Fri					
Sat			<b>Non standard timings. Where you intend to use the premises for the playing of recorded music entertainment at different times to those listed in the column on the left, please list</b> (please read guidance note 5)		
Sun					

## G

<b>Performances of dance</b> Standard days and timings (please read guidance note 6)			<u>Will the performance of dance take place indoors or outdoors or both – please tick <input checked="" type="checkbox"/> (please read guidance note 2)</u>	Indoors				
				Outdoors				
				Both				
Day	Start	Finish	<u>Please give further details here (please read guidance note 3)</u>					
Mon								
Tue								
Wed						<u>State any seasonal variations for the performance of dance (please read guidance note 4)</u>		
Thur								
Fri						<u>Non standard timings. Where you intend to use the premises for the performance of dance entertainment at different times to those listed in the column on the left, please list (please read guidance note 5)</u>		
Sat								
Sun								

## H

<b>Anything of a similar description to that falling within (e), (f) or (g)</b> Standard days and timings (please read guidance note 6)			<u>Please give a description of the type of entertainment you will be providing</u>		
Day	Start	Finish	<u>Will this entertainment take place indoors or outdoors or both – please tick <input checked="" type="checkbox"/> (please read guidance note 2)</u>	Indoor	
Mon				Outdoor	
				Both	
Tue			<u>Please give further details here (please read guidance note 3)</u>		
Wed					
Thur			<u>State any seasonal variations for entertainment of a similar description to that falling within (e), (f) or (g) (please read guidance note 4)</u>		
Fri					

Sat			<b>Non standard timings. Where you intend to use the premises for the entertainment of similar description to that falling within (e), (f) or (g) at different times to those listed in the column on the left, please list</b> (please read guidance note 5)
Sun			

<b>Provision of facilities for making music</b> Standard days and timings (please read guidance note 6)			<b>Please give a description of the facilities for making music you will be providing</b>	
<b>Will the facilities for making music be indoors or outdoors or both – please tick <input checked="" type="checkbox"/> (please read guidance note 2)</b>			Indoors	
			Outdoors	
			Both	
Day	Start	Finish	<b>Please give further details here</b> (please read guidance note 3)	
Mon				
Tue				
Wed			<b>State any seasonal variations for the provision of facilities for making music</b> (please read guidance note 4)	
Thur			<b>Non standard timings. Where you intend to use the premises for provision of facilities for making music entertainment at different times to those listed in the column on the left, please list</b> (please read guidance note 5)	
Fri				
Sat				
Sun				

<b>Provision of facilities for dancing</b> Standard days and timings (please read guidance note 6)			<b>Will the facilities for dancing be indoors or outdoors or both – please tick <input checked="" type="checkbox"/> (see guidance note 2)</b>	
			Indoors	
			Outdoors	
			Both	
Day	Start	Finish	<b>Please give a description of the facilities for dancing you will be providing</b>	

Mon			<b>Please give further details here</b> (please read guidance note 3)
Tue			
Wed			<b>State any seasonal variations for providing dancing facilities</b> (please read guidance note 4)
Thur			
Fri			<b>Non standard timings. Where you intend to use the premises for the provision of facilities for dancing entertainment at different times to those listed in the column on the left, please list</b> (please read guidance note 5)
Sat			
Sun			

## K

<b>Provision of facilities for entertainment of a similar description to that falling within J or K</b> Standard days and timings (please read guidance note 6)			<b>Please give a description of the type of entertainment facility you will be providing</b>	
Day	Start	Finish	<b>Will the entertainment facility be indoors or outdoors or both – please tick <input checked="" type="checkbox"/> (please read guidance note 2)</b>	Indoor
				Outdoor
Mon				Both
Tue			<b>Please give further details here</b> (please read guidance note 3)	
Wed				
Thur			<b>State any seasonal variations for the provision of facilities for entertainment of a similar description to that falling within j or k</b> (please read guidance note 4)	
Fri				
Sat			<b>Non standard timings. Where you intend to use the premises for the provision of facilities for entertainment of a similar description to that falling within j or k at different times to those listed in the column on the left, please list</b> (please read guidance note 5)	
Sun				

## L

<b>Late night refreshment</b> Standard days and timings (please read guidance note 6)			Will the provision of late night refreshment take place indoors or outdoors or both – please tick <input checked="" type="checkbox"/> (please read guidance note 2).	Indoors		
Day	Start	Finish		Outdoors		
Mon			<b>Please give further details here</b> (please read guidance note 3)	Both		
Tue						
Wed				<b>State any seasonal variations for the provision of late night refreshment</b> (please read guidance note 4)		
Thur						
Fri				<b>Non standard timings. Where you intend to use the premises for the provision of late night entertainment at different times, to those listed in the column on the left, please list</b> (please read guidance note 5)		
Sat						
Sun						

## M

<b>Supply of alcohol</b> Standard days and timings (please read guidance note 6)			Will the sale of alcohol be for consumption (Please tick box <input checked="" type="checkbox"/> ) (please read guidance note 7)	On the premises		
Day	Start	Finish		Off the premises		
Mon			<b>State any seasonal variations for the supply of alcohol</b> (please read guidance note 4)	Both		
Tue						
Wed				<b>Non-standard timings. Where you intend to use the premises for the supply of alcohol at different times to those listed in the column on the left, please list</b> (please read guidance note 5)		
Thur						
Fri						
Sat						

Sun			
-----	--	--	--

**State the name and details of the individual whom you wish to specify on the licence as premises supervisor**

Name.....

Address  
.....

Postcode.....

Personal Licence number(if known) .....

Issuing licensing authority .....

**N**

**Please highlight any adult entertainment or services, activities, other entertainment or matters ancillary to the use of the premises that may give rise to concern in respect of children (please read guidance note 8)**

**O**

<b>Hours premises are open to the public</b> Standard timings (please read guidance note 6)			<b>State any seasonal variation (please read guidance note 4)</b>
Day	Start	Finish	
Mon			
Tue			
Wed			
Thur			
Fri			
Sat			
Sun			



**P**

Describe the steps you intend to take to promote the four licensing objectives:

**a) General – all four licensing objectives (b,c,d,e) (please read guidance note 9)**

**b) The prevention of crime and disorder**

**c) Public safety**

**d) The prevention of public nuisance**

**e) The protection of children from harm**

Please tick ✓ yes

- I will make the payment of the fee £
- I have enclosed the plan of the premises
- I have you sent copies of this application and the plan to responsible authorities and others where applicable
- I understand that I must now advertise my application
- I understand that if I do not comply with the above requirements my application will be rejected

**IT IS AN OFFENCE, LIABLE ON CONVICTION TO A FINE UP TO LEVEL 5 ON THE STANDARD SCALE UNDER SECTION 158 OF THE LICENSING ACT 2003 TO MAKE A FALSE STATEMENT IN OR IN CONNECTION WITH THIS APPLICATION**

**Part 5 – Signatures** (please read guidance note 10)

**Signature of applicant or applicant’s solicitor or other duly authorised agent.** (See guidance note 11) **If signing on behalf of the applicant please state in what capacity.**

Signature

.....

Date.....

.....

Capacity

.....

**For joint applications signature of 2<sup>nd</sup> applicant or 2<sup>nd</sup> applicant's solicitor or other authorised agent.** (please read guidance note12) **If signing on behalf of the applicant please state in what capacity.**

Signature

.....

Date.....

.....

<b>Contact name (where not previously given) and postal address for correspondence associated with this application (please read guidance note 13)</b>	
<b>Post town</b>	<b>Post code</b>
<b>Telephone number (if any)</b>	
<b>If you would prefer us to correspond with you by e-mail your e-mail address (optional)</b>	

### Notes for Guidance

1. Describe the premises. For example the type of premises, its general situation and layout and any other information which could be relevant to the licensing objectives. Where your application includes off-supplies of alcohol and you intend to provide a place for consumption of these off-supplies you must include a description of where the place will be and its proximity to the premises.
2. Where taking place in a building or other structure please tick as appropriate. Indoors may include a tent.
3. For example the type of activity to be authorised, if not already stated, and give relevant further details, for example (but not exclusively) whether or not music will be amplified or unamplified.
4. For example (but not exclusively), where the activity will occur on additional days during the summer months.
5. For example (but not exclusively), where you wish the activity to go on longer on a particular day ie Christmas Eve.
6. Please give timings in 24 hour clock (eg 16:00) and only give details for the days of the week when you intend the premises to be used for the activity.
7. If you wish people to be able to consume alcohol on the premises please tick on, if you wish people to be able to purchase alcohol to consume away from the premises please tick off. If you wish people to be able to do both please tick both.
8. Please give information about anything intended to occur at the premises or ancillary to the use of the premises which may give rise to concern in respect of children, regardless of whether you intend children to have access to the premises, for example (but not exclusively) nudity or semi-nudity, films for restricted age groups, the presence of gaming machines.
9. Please list here steps you will take to promote all four licensing objectives together.
10. The application form must be signed.
11. A applicant's agent (for example solicitor) may sign the form on their behalf provided that they have actual authority to do so.
12. Where there is more than one applicant, both applicants or their respective agents must sign the application form.
13. This is the address which we shall use to correspond with you about this application.

RECEIVED  
07 MAR 2014

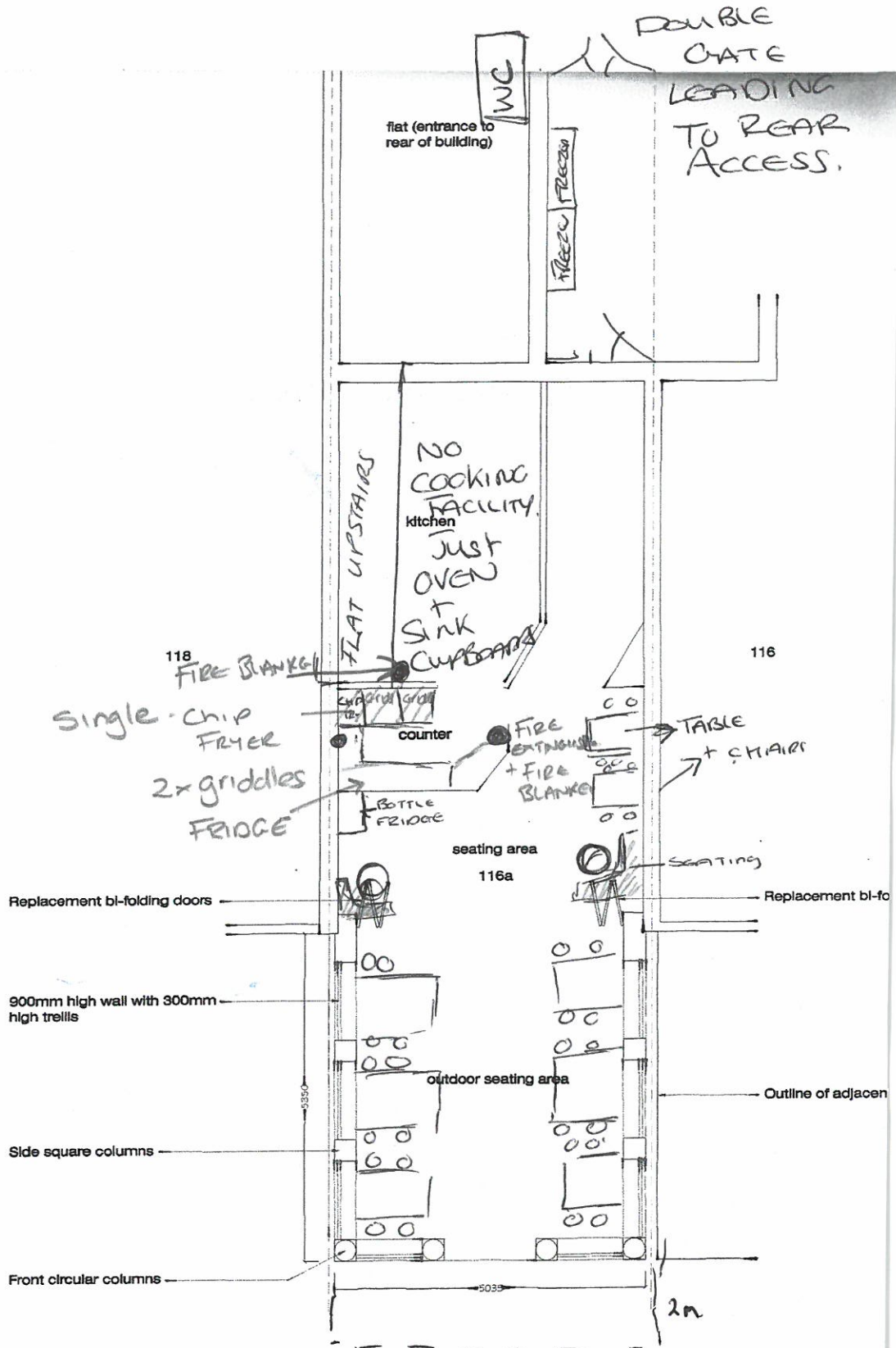

### Ground Floor Plan - As Proposed

Planning Application to  
include a walled  
Pergola at the front  
of existing shop -

LATER TO CHANGE BAY FRONT TO BI-FOLD

**From:** Wainwright, Peter

**Sent:** 25 March 2014 12:47

**To:** Licensing

**Cc:** 'Cherry, Jaqueline'

**Subject:** 2014/00918/01SPRN - Sula's Greek Cafe, 116A Portswood Road - New Premises Licence Application - REPRESENTATION

**Importance:** High

I refer to the above licence application dated 5<sup>th</sup> March 2014.

There are concerns about the likelihood of public nuisance (noise nuisance) from live music, amplified music and customer voices being suffered by residential neighbours. Also the proposed terminal hours i.e 03:00hrs for Monday to Saturday, Sunday 23:30 hrs are very late and are noise sensitive times.

In light of these concerns I am making a formal representation, on behalf of the Environmental Health Service, in relation to one of the licensing objectives: namely the prevention of public nuisance.

Peter Wainwright

Principal Environmental Health Officer

Southampton City Council