

REDBRIDGE TOWERS - ROOF
 JULY 2017 NOT TO SCALE

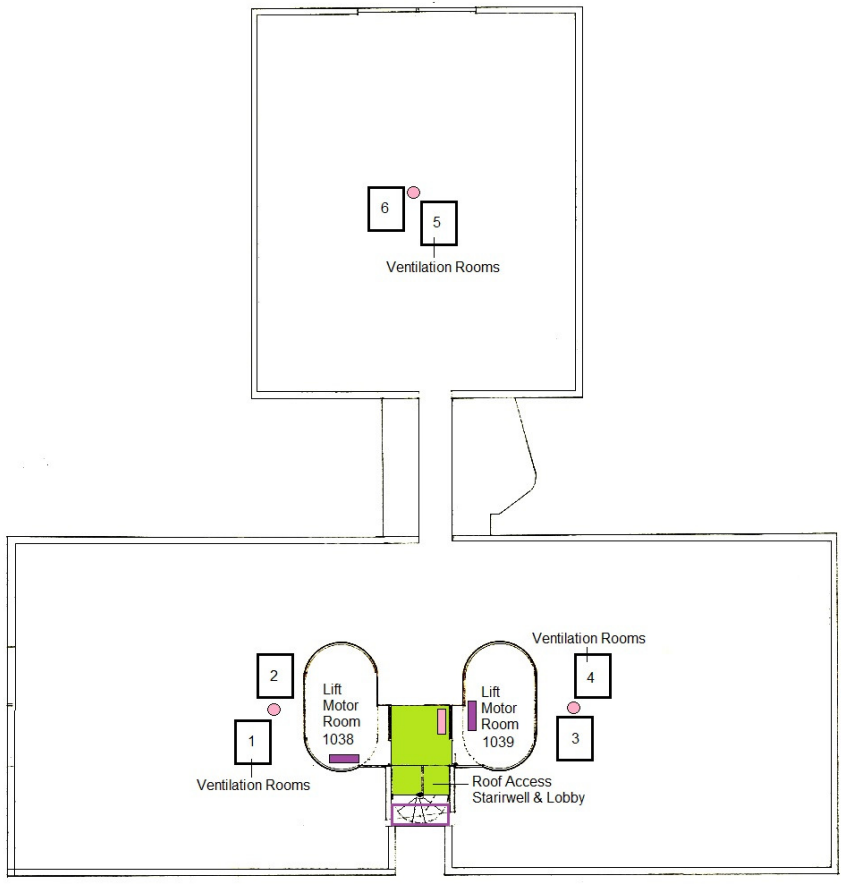

Key	
	Asbestos packing
	Asbestos rope/flashguards
	Artex (textured coating)

This plan may not illustrate all incidents of asbestos or potential asbestos associated with this property.

This plan must be read in conjunction with the asbestos property report provided by Southampton City Council's Asbestos Database.

The area/room descriptions are specific to this plan and any associated report.

Produced by Southampton City Council - Scientific Services.